

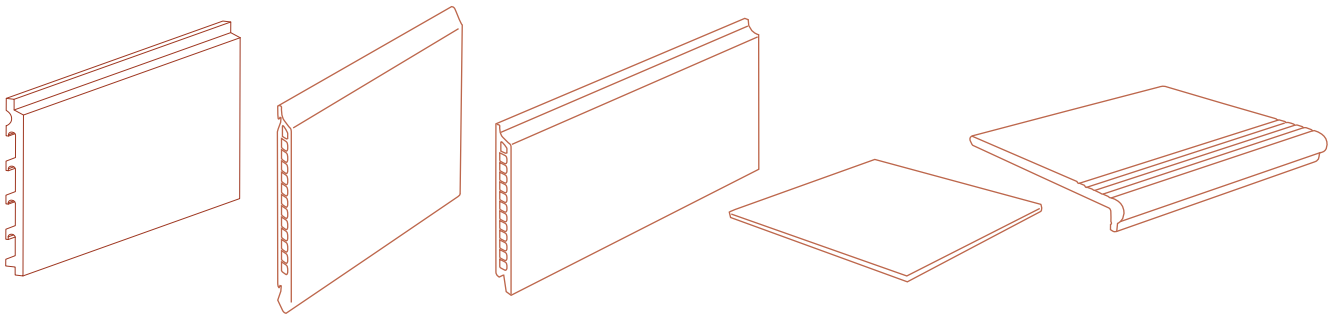

WALL POINT

Architon

Architon

<i>Architon Single Skin</i>	2
<i>Ceram</i>	6
<i>Bersal</i>	10
<i>Acqua</i>	15
<i>Louvers</i>	18
<i>Special Tiles</i>	22
<i>Cotto</i>	35



A photograph of a modern building facade. The main wall is made of red bricks. It features several rectangular windows of different sizes and colors, including purple, red, yellow, green, and white. A larger white-framed window is visible on the left. The building has a contemporary design with large glass panels and a grey concrete structure at the bottom left.

Architon enables the realization of the dreams of designers with different colors , thanks to its high production capacity , can be shipped to the site as soon as the desired sizes and colors.



Architon

Single Skin



■ Technical Specifications

Vertical System

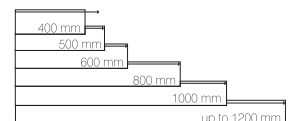
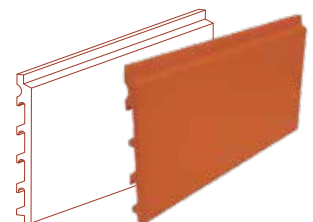
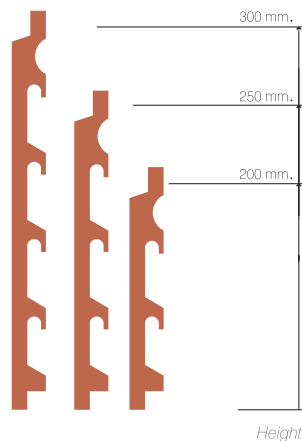

Length
Thickness 22 mm.
Weight 30 kg/m²

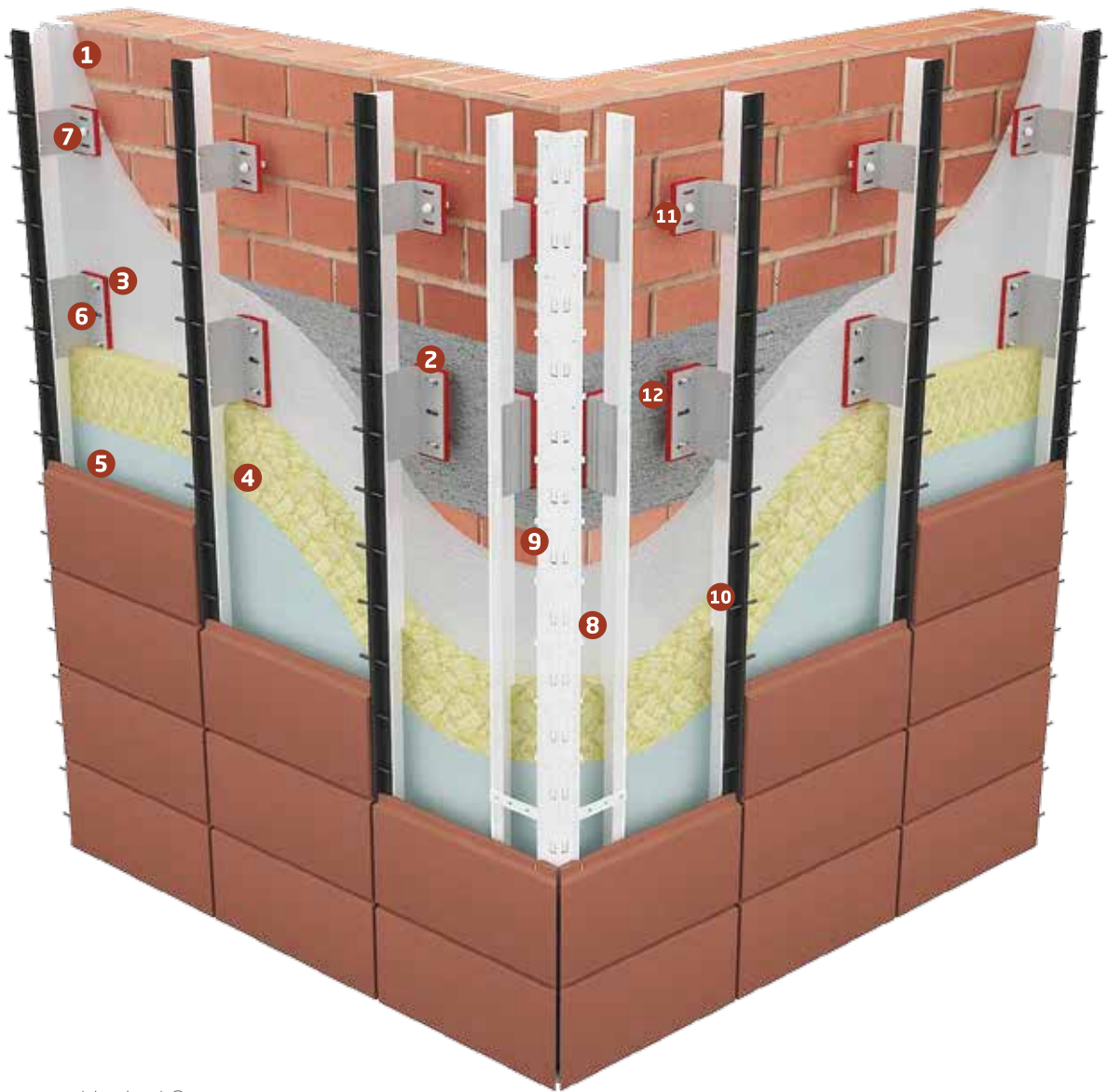

Vertical System

- | | |
|--------------------------------|--|
| 1 Brick Wall | 7 Moving İzofix Bracket |
| 2 Concrete Coating | 8 Vertical Carrier T Profile |
| 3 Plaster | 9 Fuga Hanging Profile |
| 4 Rock Wool | 10 Side Corner and End Profile |
| 5 Steam Balancing Cover | 11 Steel Screw - Brick Screw |
| 6 Fixed İzofix Bracket | 12 Connecting Screws and Rivets |

Standard Colors

Reference

Color





The 28 mm thick ceramic tile is presented in several heights and a maximum length of 1500 mm. The overlapping horizontal joints prevent water entering into the air gap, improving the technical performance of the building.

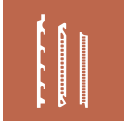

CERAM

Architon

Double Skin-Thick



Technical Specifications

Vertical System



Horizontal System

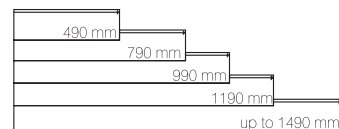
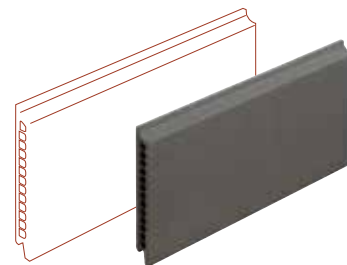
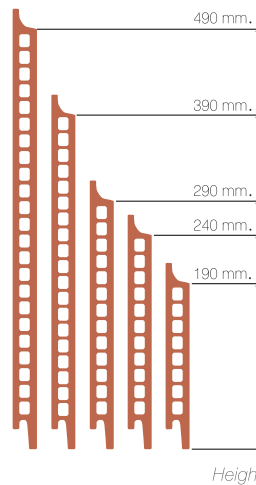

Length
Thickness 28 mm.
Weight 48 kg/m²

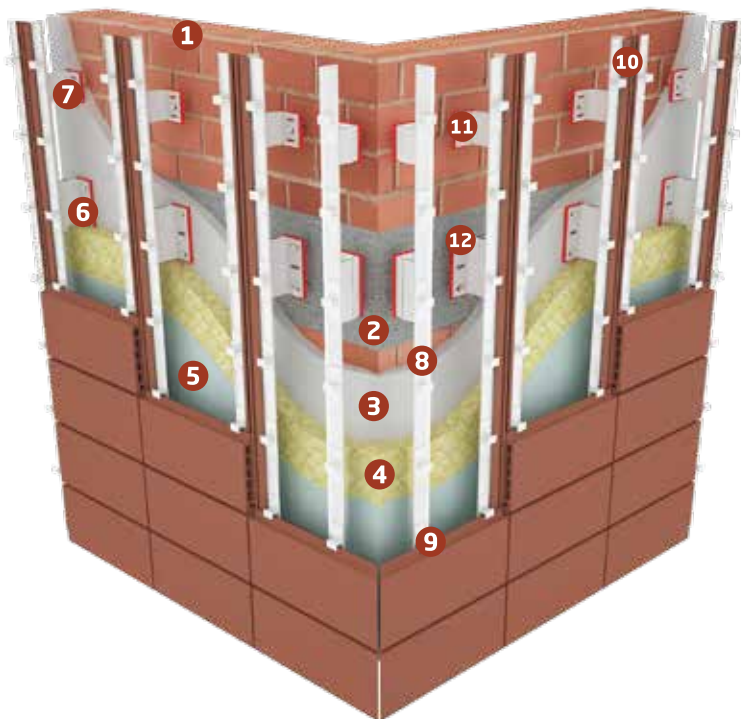

Vertical System

- 1 Brick Wall
- 2 Concrete Coating
- 3 Plaster
- 4 Rock Wool
- 5 Steam Balancing Cover
- 6 Fixed İzofix Bracket
- 7 Moving İzofix Bracket
- 8 Vertical Carrier T Profile
- 9 Inside - Bottom - Top Clips
- 10 Fuga Hanging Profile
- 11 Steel Screw - Brick Screw
- 12 Connecting Screws and Rivets

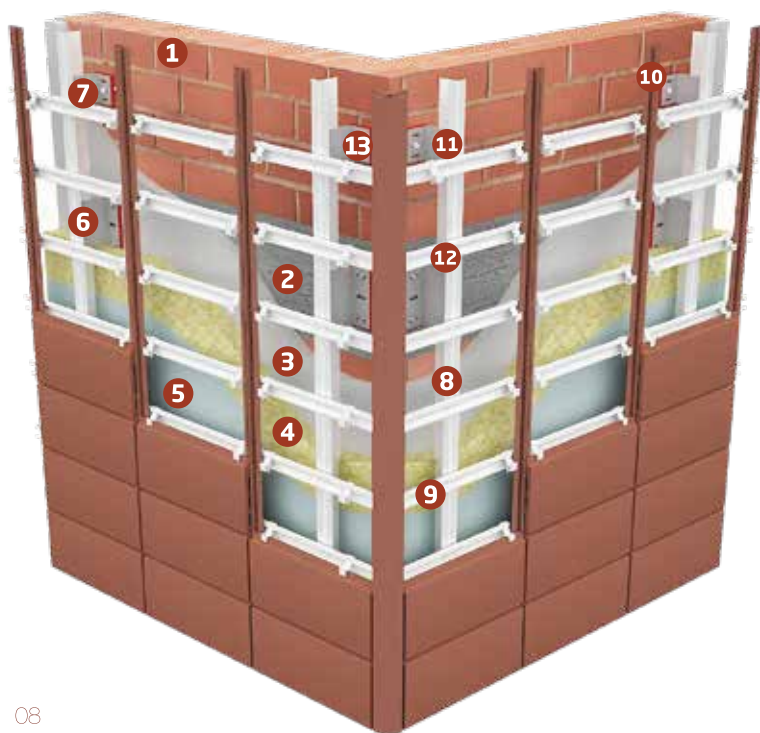

Horizontal System

- 1 Brick Wall
- 2 Moving İzofix Bracket
- 3 Fixed İzofix Bracket
- 4 Plaster
- 5 Steam Balancing Cover
- 6 Concrete Coating
- 7 Rock Wool
- 8 Vertical Carrier T Profile
- 9 Inside - Bottom - Top Clips
- 10 Fuga Hanging Profile
- 11 Steel Plastic Screw
- 12 Horizontal Carrier Profile
- 13 Connecting Screws and Rivets





Architon

CERAM^{Architon}

Double Skin-Thick

A Ref. BS07	
A Ref. NA01	
B Ref. NA03	
B Ref. TE02	
A Ref. RO011	
C Ref. NE04	
A Ref. GR03	
C Ref. AZ03	
A Ref. TU02	

Nature GR00A	
Nature MA04A	
Nature BS00A	
Nature R004A	
Nature RO021A	
Nature M5005A	
Nature M50A	

Nature GR00	
Nature MA04	
Nature BS00	
Nature R004	
Nature RO021	
Nature M5005	
Nature M50	

Metalic Colors



BERSAL

Architonic

Double Skin-Thin



Technical Specifications

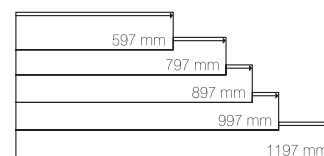
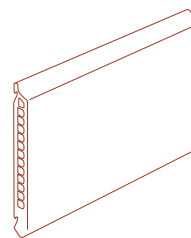
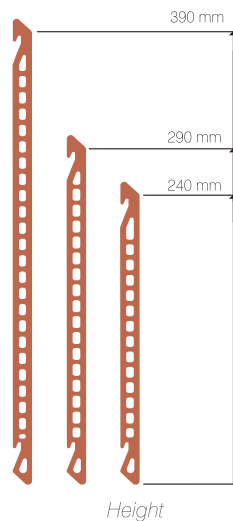

Length
Thickness 16 mm.
Weight 32 kg/m²

Architon BERSAL is 16mm thick, offers a variety of solutions has been brought to 32 kg m2. It is ideal for multi-purpose use and suitable for renovation projects.

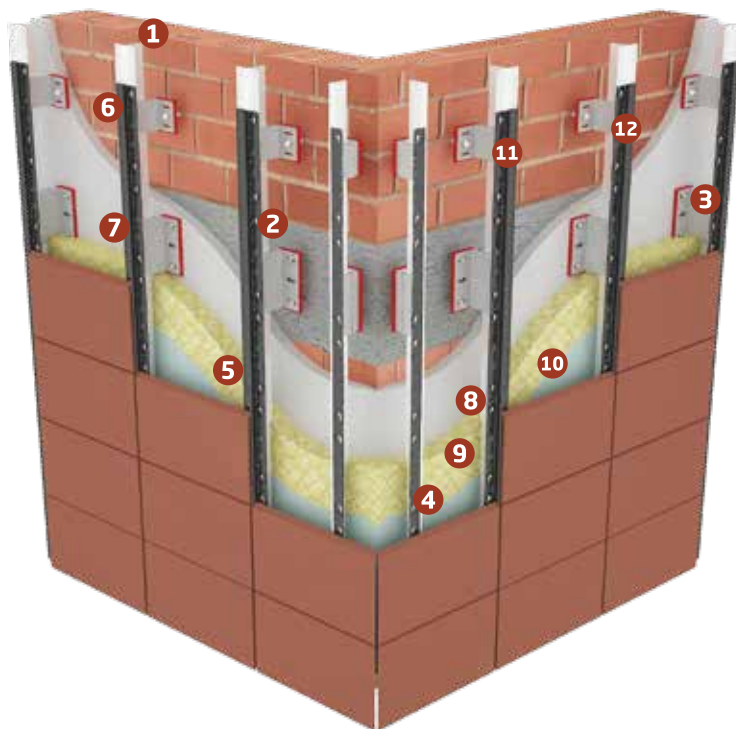

Vertical System

- 1 Brick Wall
- 2 Concrete Coating
- 3 Plaster
- 4 Rock Wool
- 5 Steam Balancing Cover
- 6 Fixed Izofix Bracket
- 7 Moving Izofix Bracket
- 8 Vertical Carrier T Profile
- 9 Steel Fuga Hanging Profile
- 10 Corner and End Profile
- 11 Steel Screw - Brick Screw
- 12 Connecting Screws and Rivets

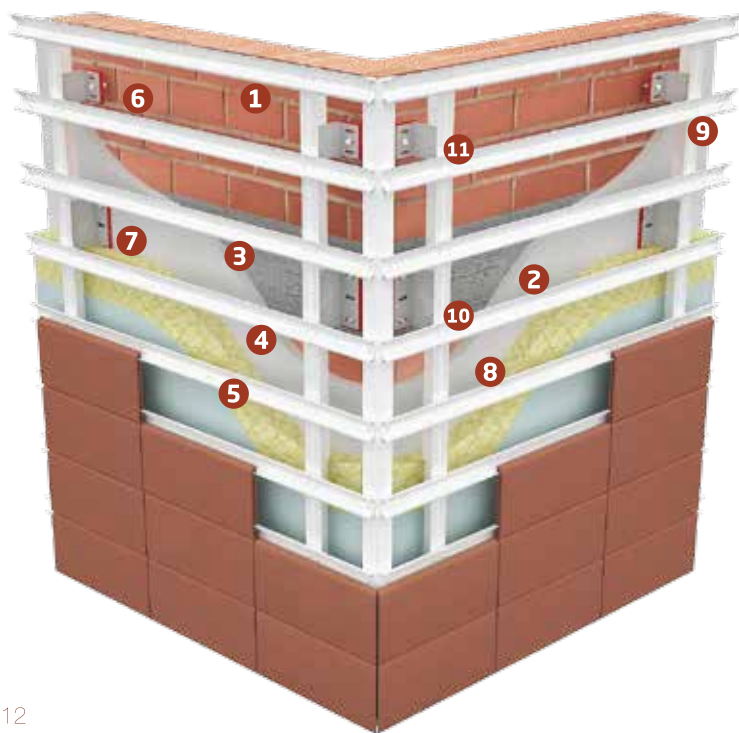

Horizontal System

- 1 Brick Wall
- 2 Moving İzofix Bracket
- 3 Fixed İzofix Bracket
- 4 Plaster
- 5 Steam Balancing Cover
- 6 Concrete Coating
- 7 Rock Wool
- 8 Vertical Carrier T Profile
- 9 Horizontal Carrier Profile
- 10 Steel Plastic Screw
- 11 Connecting Screws and Rivets



A Ref. BS07	
A Ref. NA01	
B Ref. NA03	
B Ref. TE02	
A Ref. RO011	
C Ref. NE04	
A Ref. GR03	
C Ref. AZ03	
A Ref. TU02	

Nature GR00A	
Nature MA04A	
Nature BS00A	
Nature R004A	
Nature RO021A	
Nature M5005A	
Nature M50A	

Nature GR00	
Nature MA04	
Nature BS00	
Nature R004	
Nature RO021	
Nature M5005	
Nature M50	

Metalic Colors

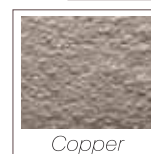



ARCHITON AQUA 's been designed to be placed in horizontal position as well in vertical position. This flexibility for installation, together with the undulating surface, provides interesting visual effects due to acting of light changes according to the installation position.

ACQUA **Archifon**



■ Technical Specifications

Vertical System

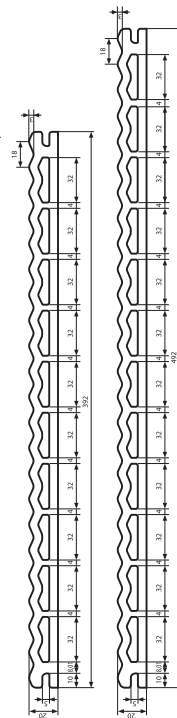
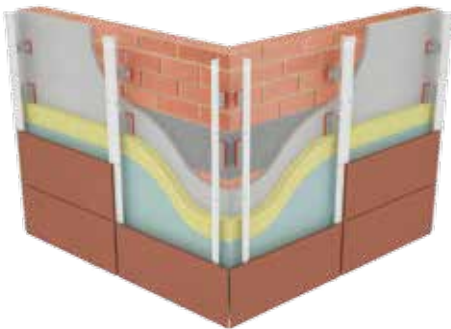

Thickness 20 mm.
Weight 48 kg/m²

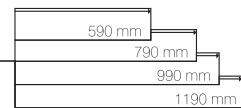

LENGTH

Length



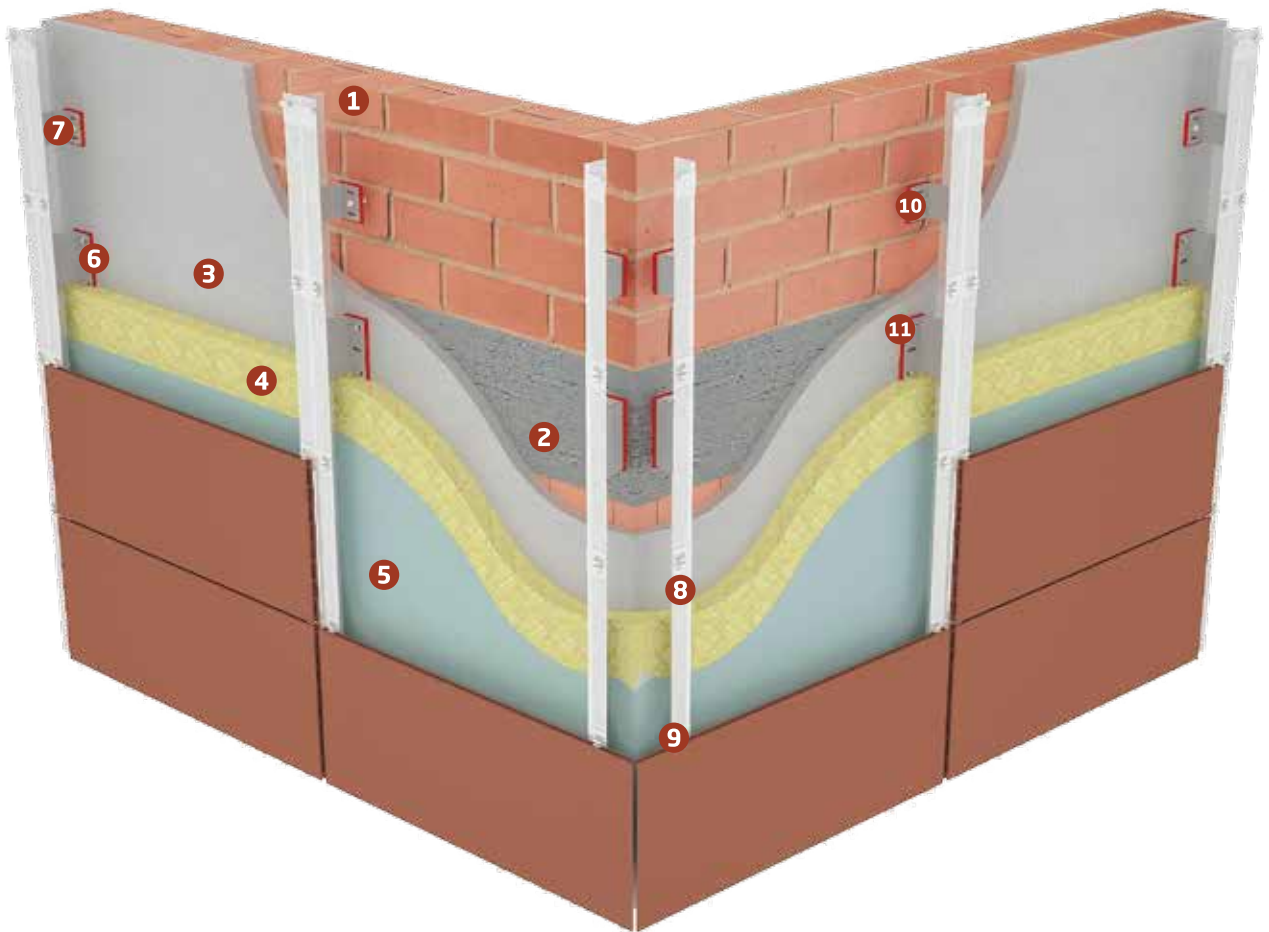

Horizontal System

- | | |
|-------------------------|---|
| 1 Brick Wall | 6 Fixed İzofix Bracket |
| 2 Concrete Coating | 7 Moving İzofix Bracket |
| 3 Plaster | 8 Vertical Carrier T Profile |
| 4 Rock Wool | 9 Stainless Bottom - Inside - Top Clips |
| 5 Steam Balancing Cover | 10 Steel Screw - Brick Screw |
| | 11 Connecting Screws and Rivets |

Acqua Application Systems

Architon

All the ARCHITON ACQUA tiles are 20 mm thick. Available in shade of green, blue and the entire ARCHITON color range.

Ventilated Facade Systems

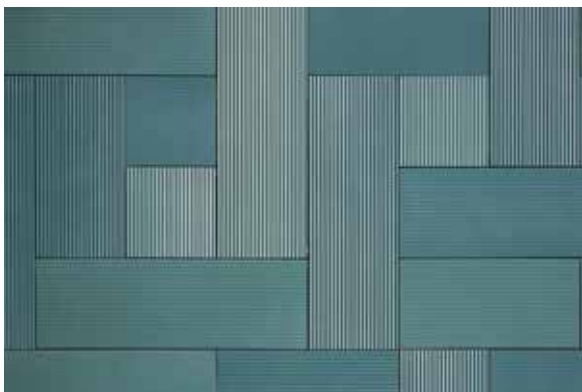

ARCHITON AQUA 's been designed to be placed in horizontal position as well in vertical position. This flexibility for installation, together with the undulating surface, provides interesting visual effects due to acting of light changes according to the installation position.



The waves of the ceramic tiles, placed in different orientations, provide volume and texture in the facade. With the impact of rays of light, the facade shows shades which give it originality and character.

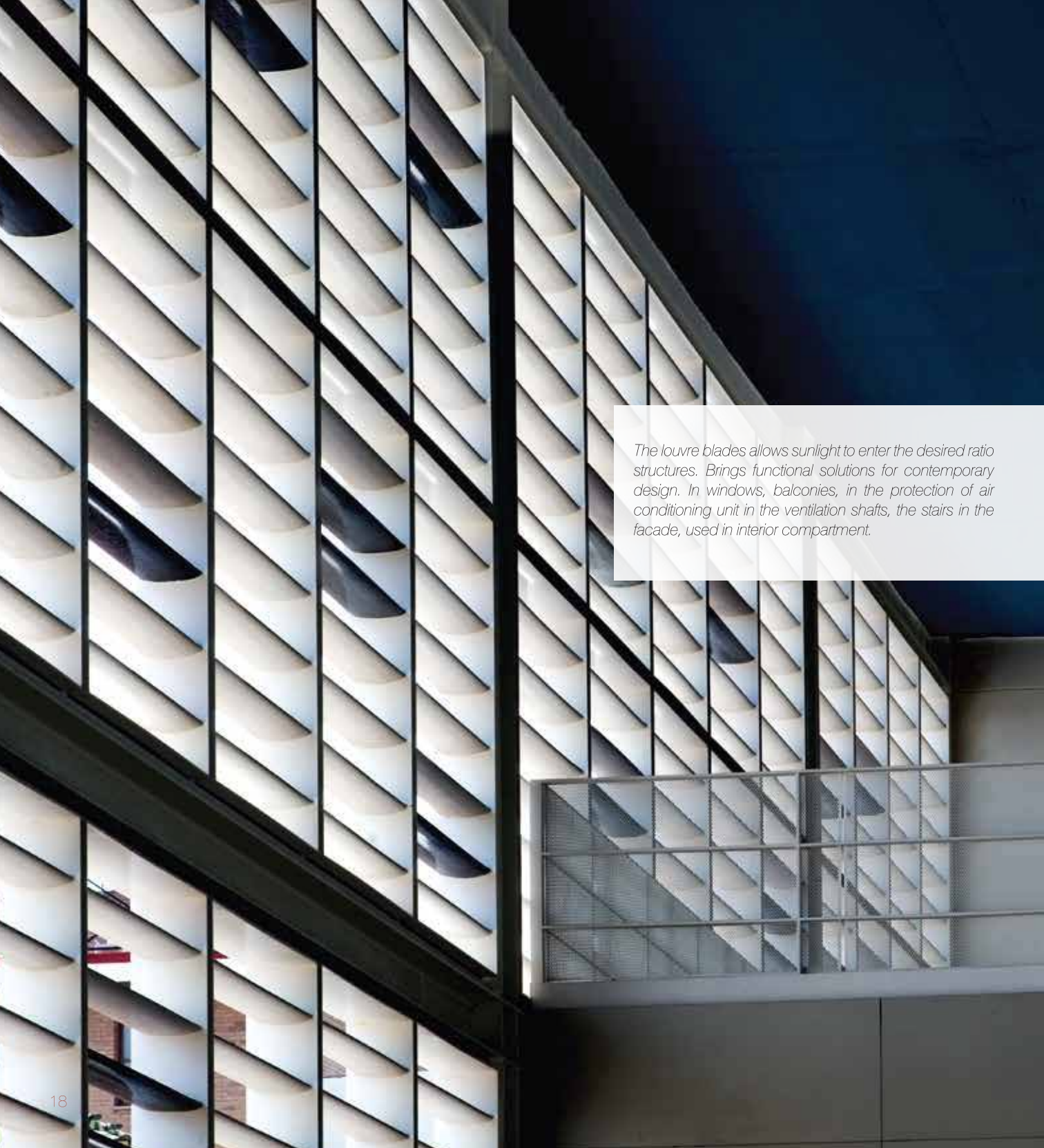

The louvre blades allows sunlight to enter the desired ratio structures. Brings functional solutions for contemporary design. In windows, balconies, in the protection of air conditioning unit in the ventilation shafts, the stairs in the facade, used in interior compartment.

Louvers



ARCHITON offers a wide variety of ceramic louvers with four different shapes: briol, java, orona, espheric

Weight

Briol

X
50 mm
60 mm

Y
50 mm
60 mm

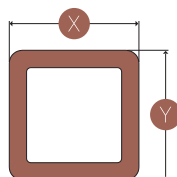

5,5 KG/ML

Java

X
60 mm
50 mm
60 mm

Y
120 mm
130 mm
150 mm

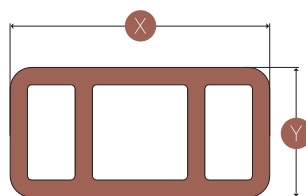

10 KG/ML

Louvers

ARCHITON offers a wide variety of ceramic louvers with four different shapes: briol, java, orona, espheric

Weight

Spheric

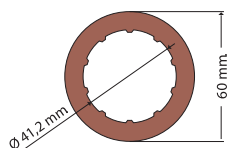

Orona

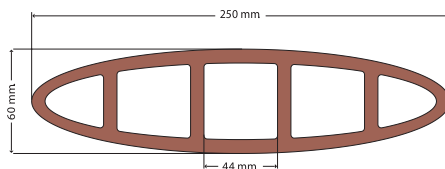

14KG/ML

Prestressed Louvers

Trough the prestressing of a louver assembly, a monolithic body is built that allows us to reach up to three meters long louvers that can be applied to different kind of louvers, reduces the supporting structure and lightens the appearance

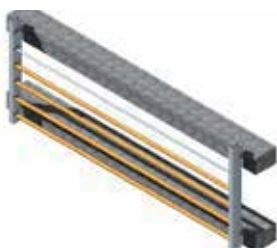

Louver Application Systems



Ventilated Facade Systems



BRIOL



JAVA



ORONA

Special Tiles

The ceramic extrusion achieves unique designs that are impossible to be made by other manufacturing process. Architon has a wide range of models and special pieces covering the basic needs of projects and adapting tiles to architectural design.

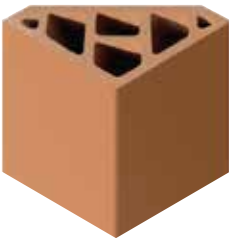
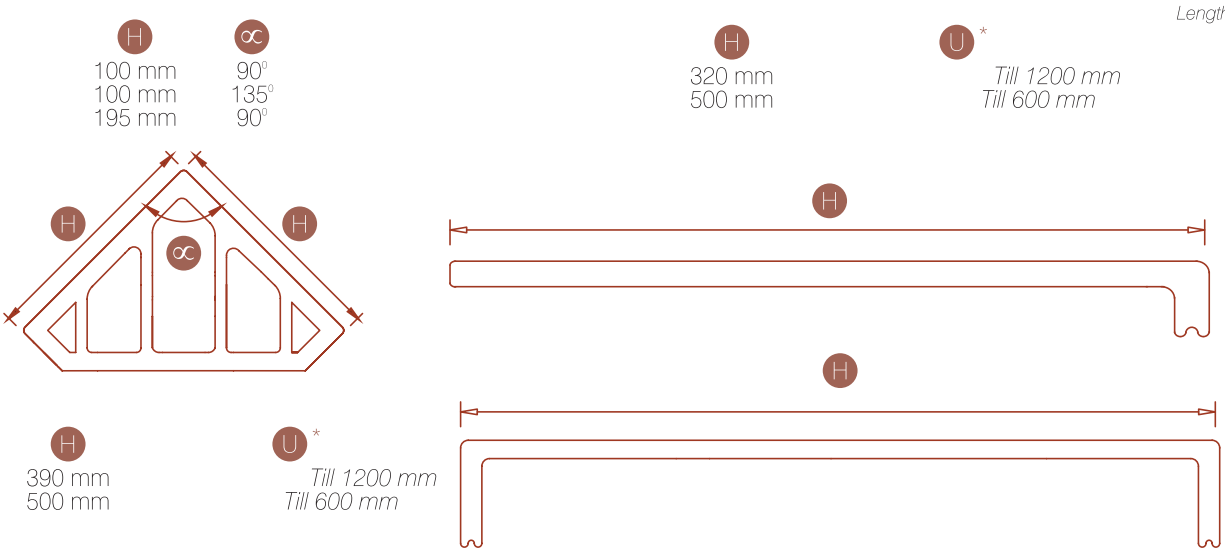

Corner



Window Sill



Copping

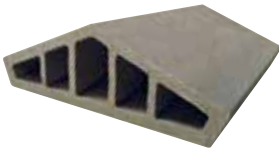
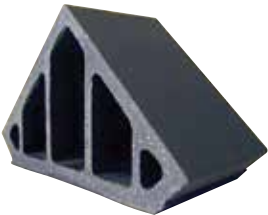















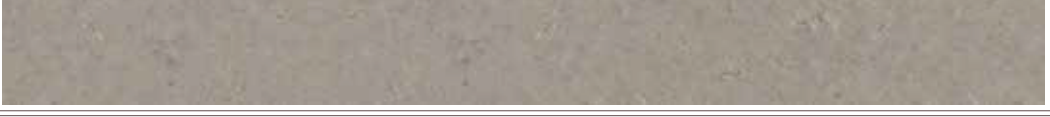

Standard and Metallic Colors

Reference	Color
A Ref. BS07	
A Ref. NA01	
B Ref. NA03	
B Ref. TE02	
A Ref. RO011	
C Ref. NE04	
A Ref. GR03	
C Ref. AZ03	
A Ref. TU02	

Metallic Colors



Natural Colors

Reference

Color

<div><i>Nature</i> GR00A</div> <div></div>	<div><i>Nature</i> GR00</div> <div></div>
<div><i>Nature</i> MA04A</div> <div></div>	<div><i>Nature</i> MA04</div> <div></div>
<div><i>Nature</i> BS00A</div> <div></div>	<div><i>Nature</i> BS00</div> <div></div>
<div><i>Nature</i> R004A</div> <div></div>	<div><i>Nature</i> R004</div> <div></div>
<div><i>Nature</i> RO021A</div> <div></div>	<div><i>Nature</i> RO021</div> <div></div>
<div><i>Nature</i> M5005A</div> <div></div>	<div><i>Nature</i> M5005</div> <div></div>
<div><i>Nature</i> M50A</div> <div></div>	<div><i>Nature</i> M50</div> <div></div>



Special Colors



Normal



Slate



Enameled

Table of Properties

Properties	Rule	Architon Values
<div>Tolerances</div> <div>According to dimensions or format.</div>	ISO 10545-2	<div><div>-</div>Length (Extrusion Direction)<div>+/- 1 mm *</div><div>-</div>Height<div>+/- 2 mm *</div><div>-</div>Thickness<div>+/- 10% *</div><div>-</div>Straightness (Extrusion Direction)<div>+/- 0,3% of length *</div><div>-</div>Rectangularity<div>+/- 1% of height</div><div>-</div>Surface Flatness<div>+/- 0,5% of diagonal or height</div></div>
Water absorption	ISO 10545-3	Depending on color <1% or 3-6%
Bending strength	ISO 10545-4	Depending on color - FVC 15-20N/mm2 – FVB 14-18N/mm2
Linear thermal coefficient of expansión	ISO 10545-8	Coefficient of expansion $5,7 \times 10^{-6}$ (K ⁻¹) Test ITC.
Resistance to thermal shock	ISO 10545-9	Unalterable up to 145°C, according to test.
Coefficient of moisture expansión	ISO 10545-10	Mean value <0,1 mm/m máximo value <0,1 mm/m Test ITC.
Frost resistance	ISO 10545-12	Unalterable according to test (100 cycles + 5°C a -5°C.)
Chemical resistance	ISO 10545-13	Only applicable in corrosive conditions. At least G and B class.
Stain resistance	ISO 10545-14	At least CLASS 3.
Color differences	ISO 10545-16	$\Delta E < 2$ -nature colors <3









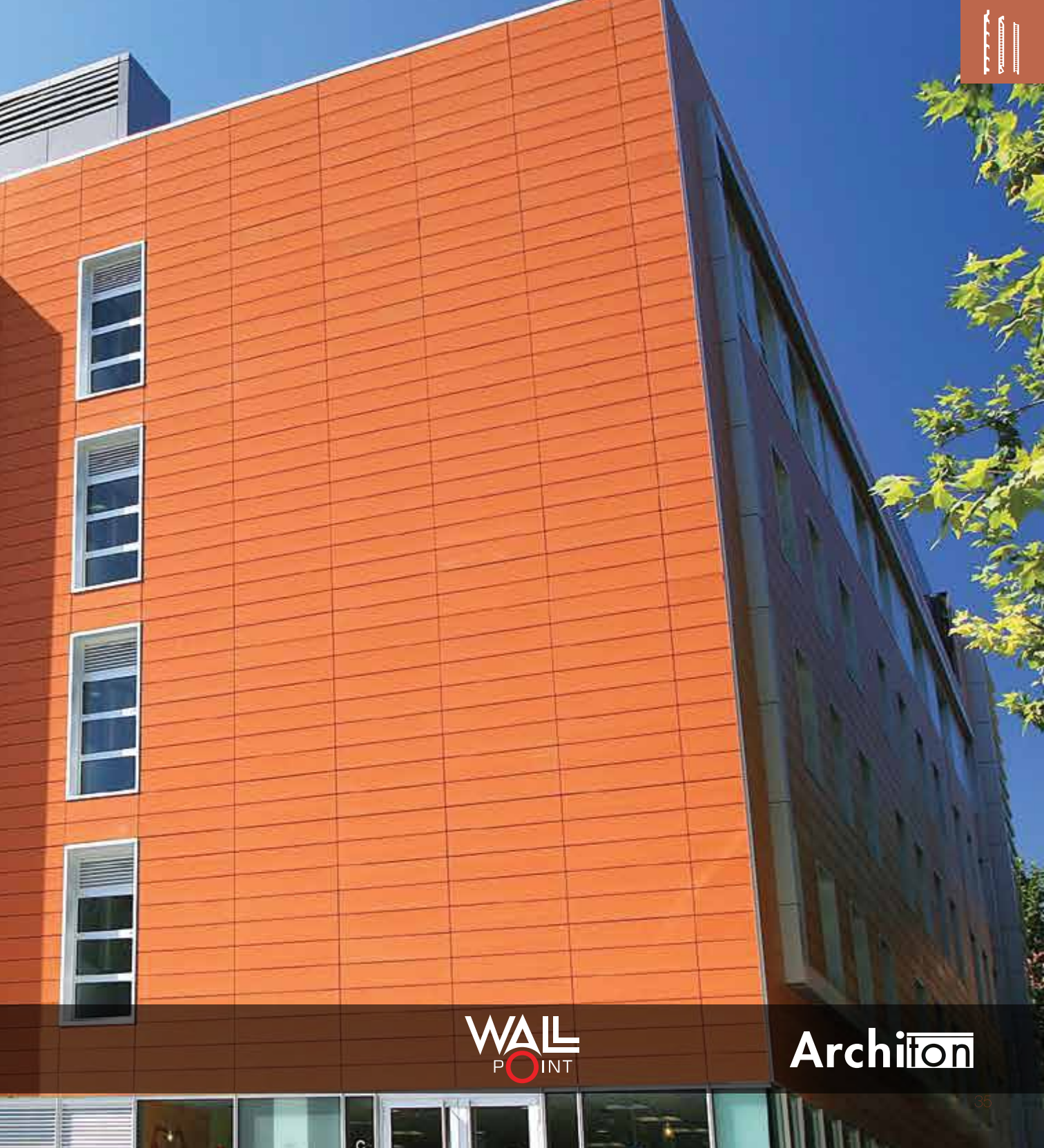



Offers technical and aesthetic solutions for buildings. Having square and rectangular forms Cotton brings functional solutions for professionals with three different colors.

COTTO

Facade

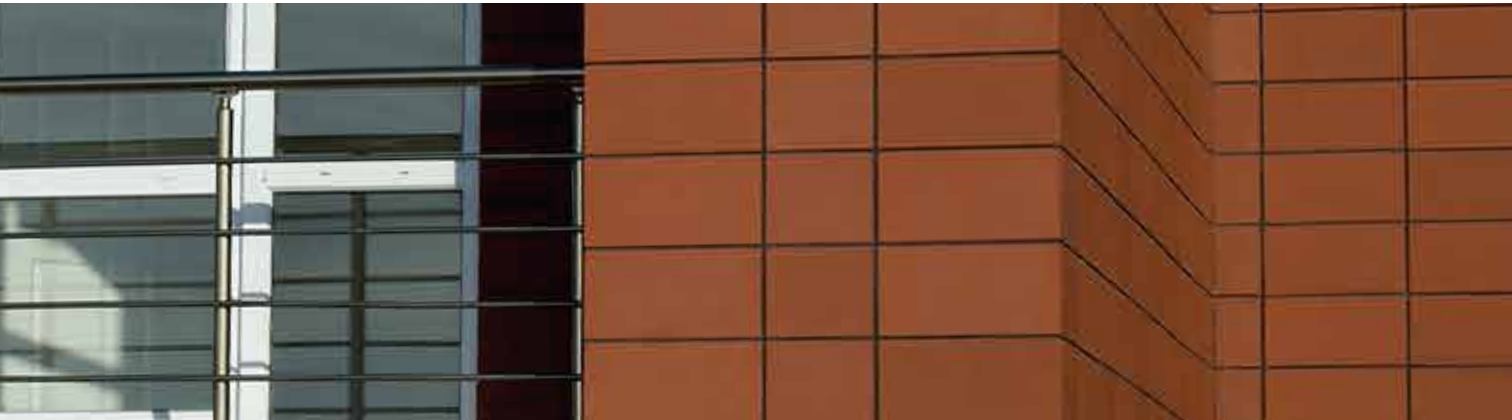

■ Technical Specifications

CT/1E Extruded

Dimension : 240x240x15 mm

Weight : 1,770 kg

pcs. / m² : 16



CT/20E Extruded

Dimension : 200x400x15 mm

Weight : 2,150 kg

pcs. / m² : 12,5



COTTO

Facade



■ *Technical Specifications*

CT/20E-S Extruded

Dimension : 200x400x15 mm

Weight : 2,150 kg

pcs. / m² : 12,5





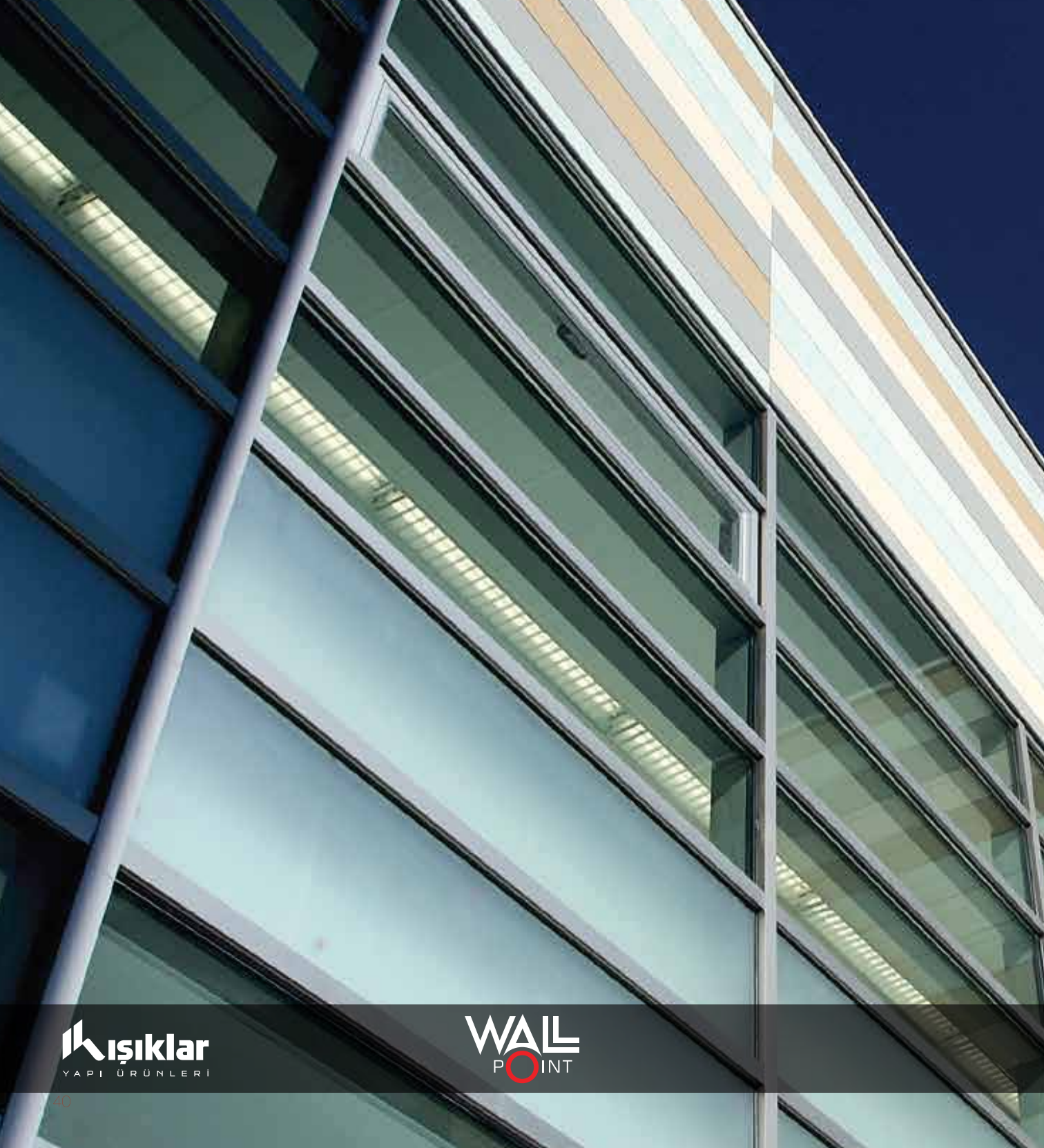







**There may be color changes in products sourced from printing.*



Lights shine where there are buildings,
“**ışıklar**” will be shining where life is!



 Sos. de Centura, Comuna Tunari, Nr. 24-26, Hala SRT4, 077180

 0314 100 300

 0314 100 301

 0314 100 302

 contact@wallpoint.ro

 www.wallpoint.ro

 0314 100 300